

# Power Extender

700MO2P\_

1.6



## POWER FEED

### GENERAL PRODUCT INFORMATION:



This product is suitable for indoor dry locations only.

This product must be used with a Tech Lighting Two-Circuit MonoRail power feed canopy or surface transformer.

When using a power vault adapter with the extender rod, refer to the instructions provided with the power vault adapter.

## Extending the Power Feed Canopy

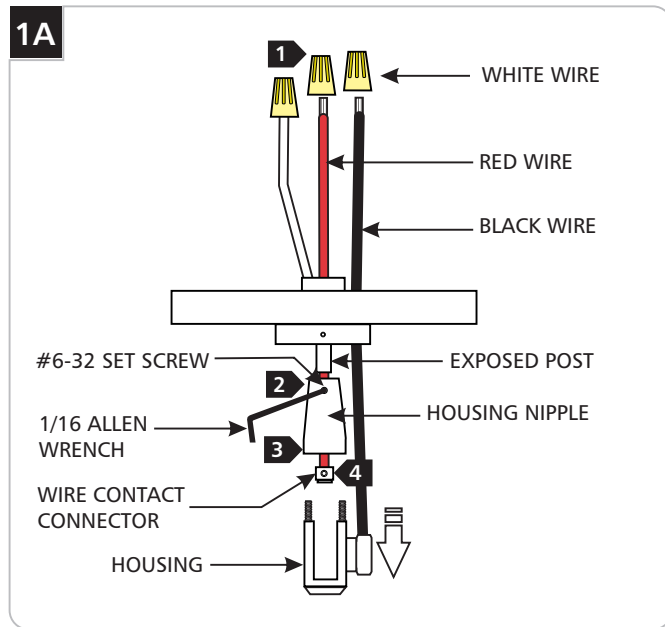

- 1** Remove the wire nuts from the red and black wires.
- 2** Loosen the #6-32 set screw on the housing nipple with the 1/16 Allen wrench.
- 3** Unscrew the housing from the housing nipple by twisting the housing nipple counterclockwise.
- 4** Pull the housing and housing nipple out from the canopy.
- 5** Discard the red wire with the wire contact connector.



**CAUTION—RISK OF FIRE**  
 This product requires installation by a qualified electrician. Before installing be sure to read all instructions and **TURN THE POWER TO THE ELECTRICAL BOX OFF.**

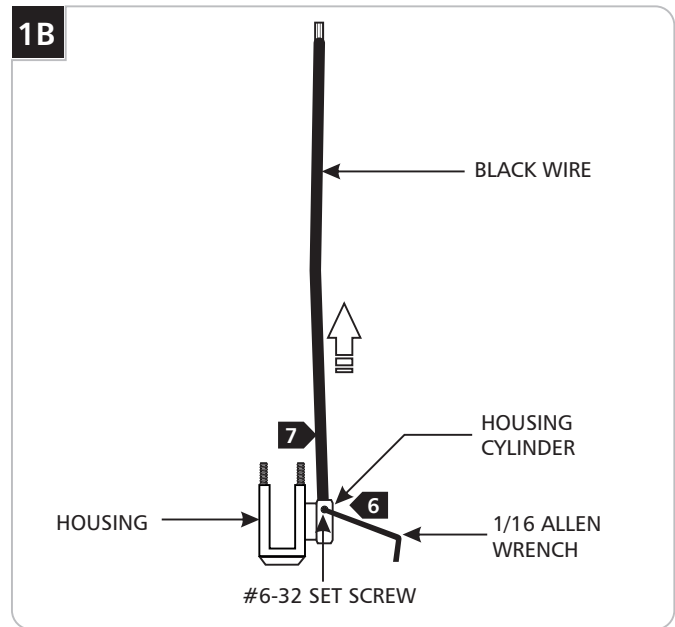

- 6** Loosen the #6-32 set screw on the housing cylinder with the 1/16 Allen wrench.
- 7** Remove and discard the black wire.

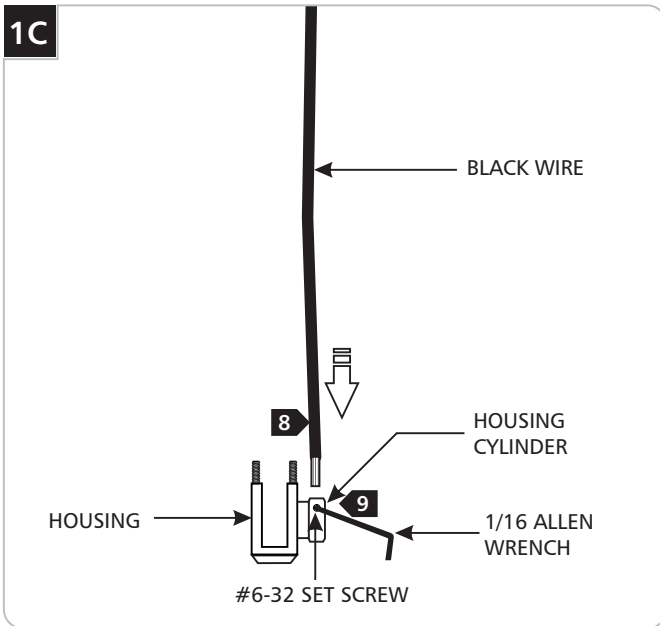
**1C**

- 8** From one end of the new black wire (provided with the power extender), strip off 1/4" of the insulation.
- 9** Feed the stripped portion into the housing cylinder and tighten the #6-32 set screw with the 1/16 Allen wrench.

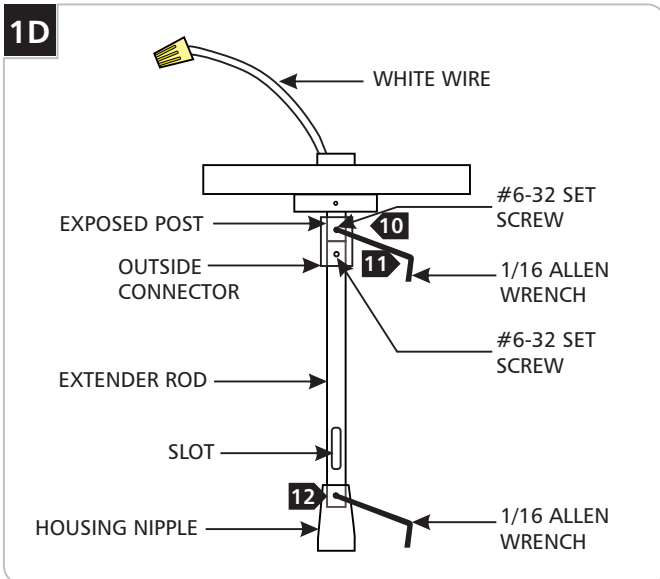
**1D**

- 10** Place the outside connector half way onto the exposed post and tighten the #6-32 set screw with the 1/16 Allen wrench.
- 11** Push the solid side of the extender rod (the side without the slot) all the way into the outside connector and tighten the #6-32 set screw with the 1/16 Allen wrench.
- 12** Push the housing nipple completely onto the end of the extender rod (the side with the slot) and tighten the #6-32 set screw with the 1/16 Allen wrench.

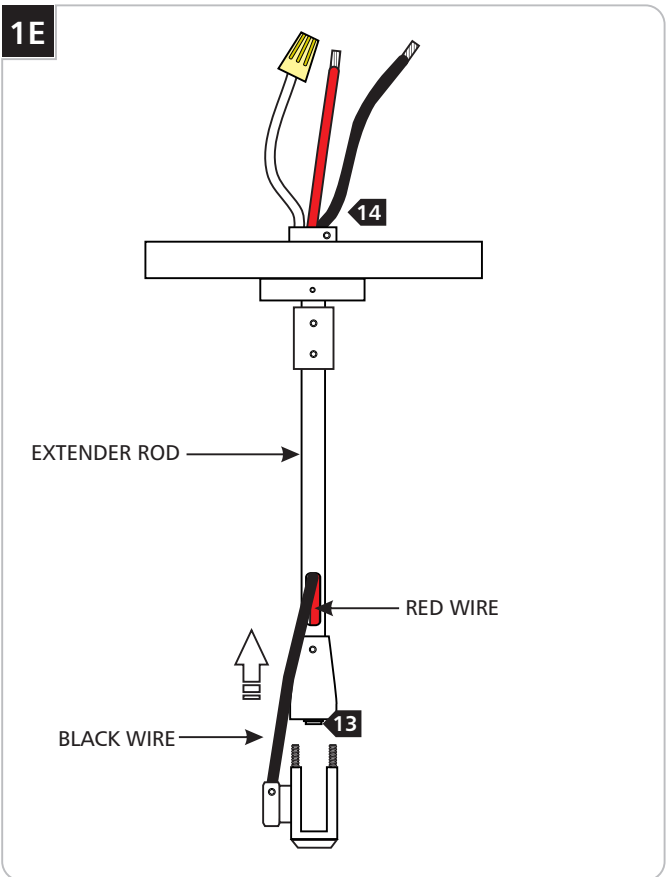
**1E**

- 13** Push the new red wire assembly (provided with the package) through the housing nipple into the extender rod, at the same time feed the black wire through the slot into the power extender rod.
- 14** Push both black and red wires together into the canopy.
- 15** Refer to the instruction provided with the power feed canopy to complete the installation.

# Extending the Surface Transformer

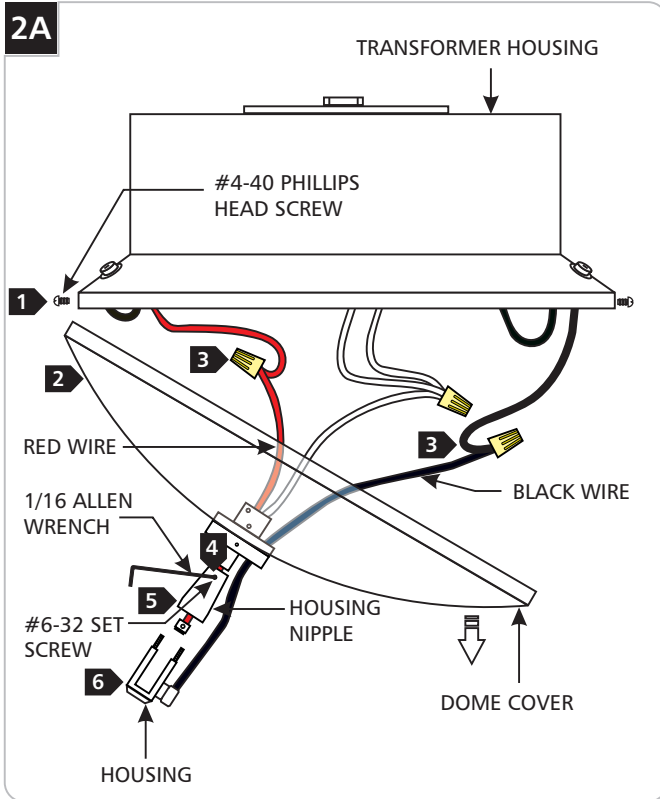

**NOTE:** The Two-Circuit MonoRail power feed extenders are cut to size for Two-Circuit MonoRail power feed canopies. When using the power extender to extend the surface mount transformer, use the table below to cut to size the extender rod.

- 1 Remove the #4-40 Phillips head screws on the side of the surface mount transformer.
- 2 Lift the dome cover off of the transformer housing.
- 3 Disconnect the red and black dome cover wires from the circuit breaker wires by removing the wire nuts.
- 4 Loosen the #6-32 set screw on the housing nipple with the 1/16 Allen wrench.
- 5 Unscrew the housing from the housing nipple by twisting the housing nipple counterclockwise.
- 6 Pull the housing with the black and red wires off of the exposed post.

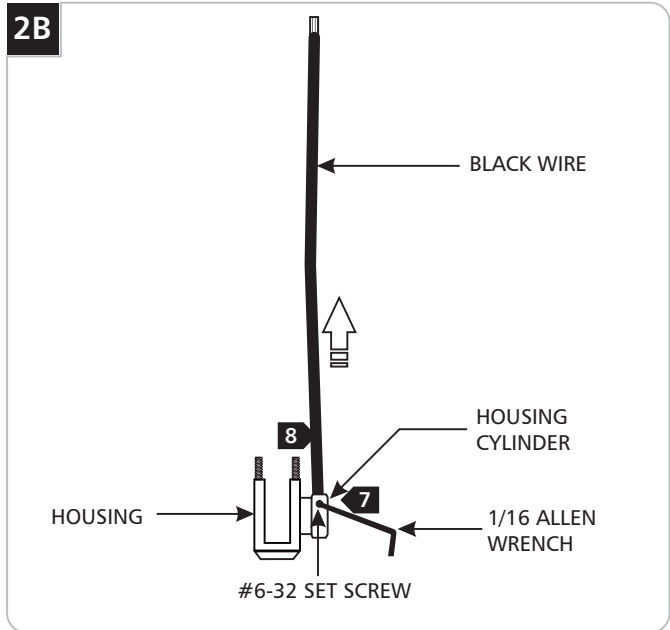

- 7 Loosen the #6-32 set screw on the housing cylinder with the 1/16 Allen wrench.
- 8 Remove and discard the black wire.

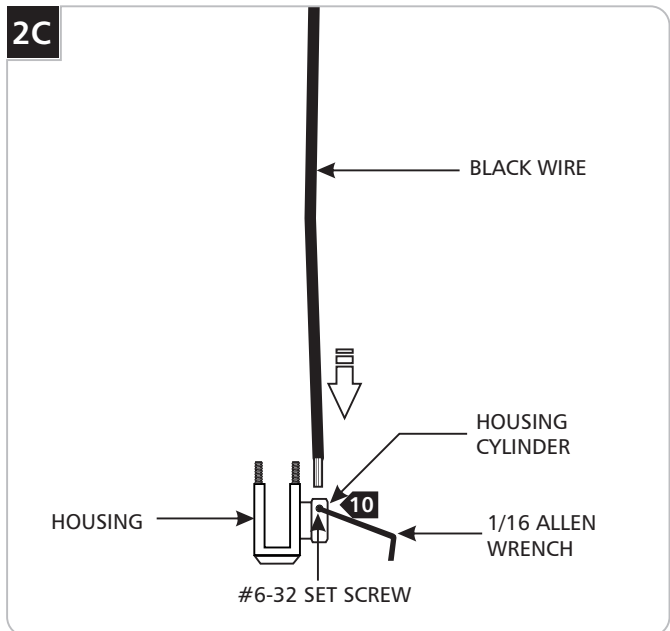

- 9 From one end of the new black wire (provided with the power extender), strip off 1/4" of the insulation.
- 10 Feed the stripped portion into the housing cylinder and tighten the #6-32 set screw with the 1/16 Allen wrench.

TYPE OF SRT	FOR 3" EXTENSION	FOR 6" EXTENSION	FOR 12" EXTENSION	FOR 24" EXTENSION	FOR 36" EXTENSION	FOR 48" EXTENSION	FOR 96" EXTENSION
SRT 600	N/A	N/A	6-1/4"	18-1/4"	30-1/4"	42-1/4"	90-1/4"

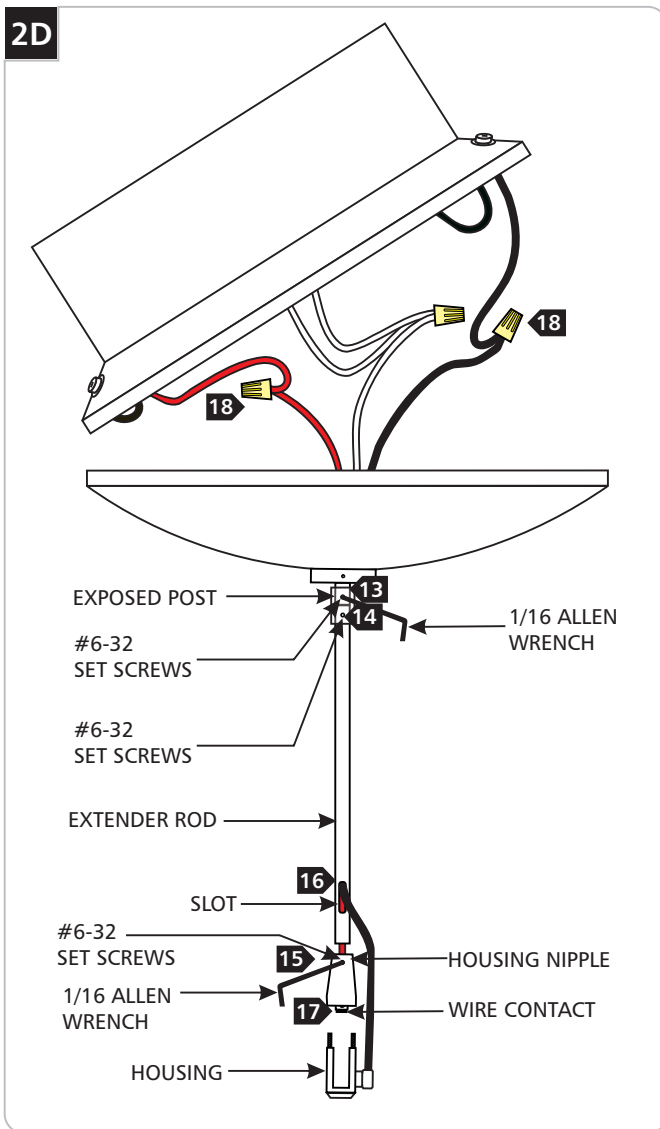
**2D**

- 11** Cut the extender rod from the solid side (the side without the slot) to the proper length with a hack saw (use the table on page 3).
- 12** Clean the burrs in the cut section.
- 13** Place the outside connector halfway onto the exposed post and tighten the #6-32 set screw with the 1/16 Allen wrench.
- 14** Push the solid side of the extender rod (the side without the slot) all the way into the outside connector and tighten the #6-32 set screw with the 1/16 Allen wrench.
- 15** Push the housing nipple completely onto the extender rod and tighten the #6-32 set screw with the 1/16 Allen wrench.
- 16** Push the new red wire assembly through the housing nipple into the extender rod, at the same time feed the black wire through the slot into the power extender rod. Push both black and red wires together into the transformer.
- 17** Make sure that the red wire is completely in so that the wire contact connector sits flush on the housing nipple.
- 18** Connect the red and black wires to the circuit breaker wires with the wire nuts.
- 19** Refer to the instruction provided with the surface mount transformer to complete the installation.

**SAVE THESE INSTRUCTIONS!**



7400 Linder Ave, Skokie, IL 60077  
847.410.4400

[www.techlighting.com](http://www.techlighting.com)

© 2008 Tech Lighting, L.L.C. All rights reserved. The "Tech Lighting" graphic is a registered trademark of Tech Lighting, L.L.C. Tech Lighting reserves the right to change specifications for product improvements without notification.  
A Generation Brands Company