

# SATINLESS STEEL HASP

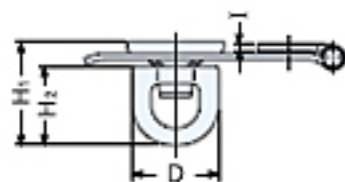

HP



HP-40/50  
Rotating eye

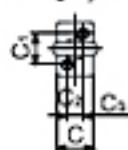

HP-75/100  
Mounting Plate

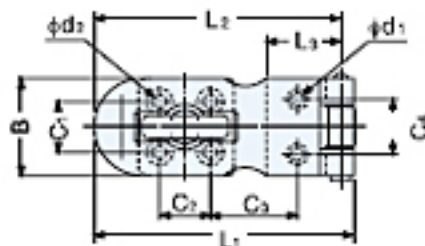
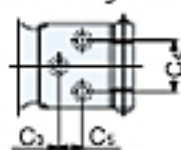

HP-120  
Mounting Plate

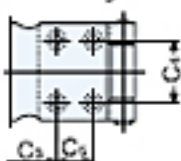

Material	Finish
304 Stainless Steel	Polished

Item No.	L1	L2	L3	B	C1	C2	C3	C4	C5	H1	H2	C	D	I	d1	d2	Weight (g)	Box (pcs)	Carton (pcs)
HP- 40	40 (1-37/64")	37	13	22 ( 7/8" )	13	6.4	10.8	12	-	22 ( 55/64" )	17.9	15.3	17.7	1.2	3	3	21.5	30	300
HP- 50	50 (1-31/32")	47	13	22.3 ( 7/8" )	13	9	16	12	-	22 ( 55/64" )	17.9	18.3	17.7	1.2	3	3	24	25	250
HP- 65	65 ( 2-9/16" )	62	19	24 ( 15/16" )	13	13	21.5	14	-	24.5 ( 31/32" )	20.4	24.5	22.5	1.5	3.2	3.2	41.5	20	200
HP- 75	75 (2-61/64")	72	24.8	27 ( 1-1/16" )	15	15	15.7	16	9.5	27.4 ( 1-5/64" )	22	27.8	23.2	1.5	3.8	3.8	51.5	15	150
HP-100	100 (3-15/16")	95	30	35.5 (1-25/64")	19	19	29	21	10	32.2 (1-17/16")	27.9	35.5	31	2	4	4.5	118.5	10	100
HP-120	120 (4-23/32")	115	35.5	40 (1-37/64")	21	22	38	26	15	34.8 ( 1-3/8" )	27.9	40.5	31	2.5	5.2	5.2	172	8	80