



TRAC-MASTER®

Avant Garde GYRUS™

T640 and T645

Project: _____

Fixture Type: _____

Location: _____

Contact/Phone: _____

PRODUCT DESCRIPTION

A new spin on an old idea, the Gyrus™ combines dramatic aerodynamic styling with the convenience of a front relamping gimbal ring. The MR16 has an integrated accessory holder that accepts standard up to two 2" diameter lenses and louvers. An optional snap-in, dual-media cartridge is available for the PAR30 that smartly integrates into the fixture design.

Aiming 90° vertical aiming capability and 358° rotation.

Construction Die-cast aluminum lamp housing • Extruded aluminum support stem conceals lamp lead wires.

Labels UL listed, CSA certified • Union made, AFL-CIO.



Low Voltage MR16 - Gyrus™

Lamp 20-50W MR16 lamps.

Socket Ceramic bi-pin.

Lens Glass lens included with lampholder • May be used with up to two accessories simultaneously.

Construction Die-cast aluminum lamp housing • Extruded aluminum support stem conceals lamp lead wires.

Transformer T537 or T538 12V solid state electronic transformer with on/off switch or Juno Trac-Master low voltage monopoint. Must be ordered separately. Dimmable, see spec sheet D1.2.1

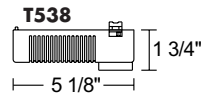
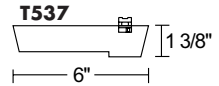

Catalog Number	Description	Finish	Lamp
T640WH	Gyrus™	White	20-50W MR16
T640BL	Gyrus™	Black	20-50W MR16
T640SL	Gyrus™	Silver	20-50W MR16

ACCESSORIES

Cat. No.	Description	Cat. No.	Description	Cat. No.	Description
T741-6	Color Filters/Lenses	T7477	Prismatic Spread Lens	T7478	Linear Spread Lens
T7401-18	Dichroic Lenses	T7420	Diffuse Spread Lens	T7421	Uniformity Lens
T7422	UV Filter Lens	T7459BL	Hexcell Louver		

See specification sheet D1.2.2 for details.

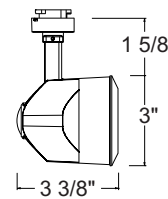

Line Voltage PAR30 - Gyrus™

Lamp 50-75W PAR30.

Socket Ceramic bi-pin.

Construction Die-cast aluminum lamp housing • Extruded aluminum support stem conceals lamp lead wires.

Adapter Copper alloy contacts provide precise spring action - no arcing and will not take a set • True, positive electrical ground • Spring-loaded positive latch polarity indicator embossed on copper contact • "Pull-up" contact to up position for two-circuit application.

Catalog Number	Description	Finish	Lamp
T645WH	Gyrus™	White	50-75W PAR30
T645BL	Gyrus™	Black	50-75W PAR30
T645SL	Gyrus™	Silver	50-75W PAR30

Catalog Number	Description	Finish	Accessory
T645MC-WH	Media Cartridge	White	Compatible with up to two 3 3/4" accessories as noted below
T645MC-BL	Media Cartridge	Black	Compatible with up to two 3 3/4" accessories as noted below
T645MC-SL	Media Cartridge	Silver	Compatible with up to two 3 3/4" accessories as noted below

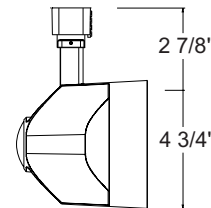

ACCESSORIES

Cat. No.	Description	Cat. No.	Description	Cat. No.	Description
T569BL	Black Louver	T577BL	Black Eyebrow	T660BL	Black Filter Holder
T561-6	Color Filters	T5677	Prismatic Spread Lens	T5678	Linear Spread Lens
T5621	Uniformity Lens	T5622	UV Filter		

See specification sheet D1.2.2 for details.

TRAC-MASTER®

Avant Garde

GYRUS™

T640 and T645

CBCP • Centerbeam candlepower
FC • Footcandles at beam center (aim point)

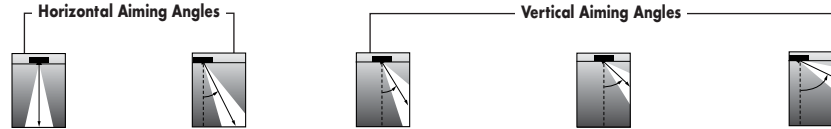

Lamp	Beam Type	Beam Spread°	Rated Life	CBCP	0°		30°			30°			45°			60°									
					MH	FC	L	W	FC	L	W	D	FC	X	L	W	FC	X	L	W	D	FC	X	L	W
Q35W MR16	SP	20°	5000	3900	4	244	1.4	1.4	158	1.9	1.6	2	122	3.5	3.1	1.4	345	2.0	1.5	1.0	4	158	2.3	1.9	1.6
					6	108	2.1	2.1	70	2.8	2.4	3	54	5.2	4.7	2.1	153	3.0	2.2	1.5	6	70	3.5	2.8	2.4
					8	61	2.8	2.8	40	3.8	3.3	4	31	6.9	6.2	2.8	86	4.0	2.9	2.0	8	40	4.6	3.8	3.3
					10	39	3.5	3.5	25	4.7	4.1	5	20	8.7	7.8	3.5	55	5.0	3.6	2.5	10	25	5.8	4.7	4.1
					12	27	4.2	4.2	18	5.7	4.9	6	14	10.4	9.3	4.2	38	6.0	4.4	3.0	12	18	6.9	5.7	4.9
Q50W MR16	NSP	15°	6000	9100	4	638	1.0	1.0	414	1.3	1.1	2	319	3.5	2.1	1.0	902	2.0	1.0	0.7	8	104	4.6	2.6	2.3
					6	283	1.5	1.5	184	2.0	1.7	3	142	5.2	3.1	1.5	401	3.0	1.5	1.0	10	66	5.8	3.3	2.8
					8	159	2.0	2.0	104	2.6	2.3	4	80	6.9	4.1	2.0	225	4.0	2.0	1.4	12	46	6.9	3.9	3.4
					10	102	2.5	2.5	66	3.3	2.8	5	51	8.7	5.1	2.5	144	5.0	2.5	1.7	14	34	8.1	4.6	4.0
	NFL	25°	6000	3200	4	213	1.9	1.9	138	2.6	2.2	2	106	3.5	4.6	1.9	301	2.0	2.0	1.4	4	138	2.3	2.6	2.2
					6	94	2.9	2.9	61	3.9	3.3	3	47	5.2	7.0	2.9	134	3.0	3.1	2.0	6	61	3.5	3.9	3.3
					8	53	3.8	3.8	35	5.2	4.4	4	27	6.9	9.3	3.8	75	4.0	4.1	2.7	8	35	4.6	5.2	4.4
					10	34	4.8	4.8	22	6.5	5.5	5	17	8.7	11.6	4.8	48	5.0	5.1	3.4	10	22	5.8	6.5	5.5
	FL	40°	6000	1700	4	116	2.9	2.9	75	4.1	3.4	2	58	3.5	9.6	2.9	164	2.0	3.4	2.1	4	75	2.3	4.1	3.4
					6	51	4.4	4.4	33	6.1	5.0	3	26	5.2	14.5	4.4	73	3.0	5.0	3.1	6	33	3.5	6.1	5.0
					8	29	5.8	5.8	19	8.1	6.7	4	14	6.9	19.3	5.8	41	4.0	6.7	4.1	8	19	4.6	8.1	6.7
					10	19	7.3	7.3	12	10.2	8.4	5	9	8.7	24.1	7.3	26	5.0	8.4	5.1	10	12	5.8	10.2	8.4
					12	13	8.7	8.7	8	12.2	10.1	6	6	10.4	**	8.7	18	6.0	10.1	6.2	12	8	6.9	12.2	10.1

Lamp	Beam Type	Beam Spread°	Rated Life	CBCP	0°		30°		30°			45°			60°										
					MH	FC	L	W	FC	L	W	D	FC	X	L	W	FC	X	L	W	D	FC	X	L	W
75W PAR30 Halogen	SP	10°	2000	13000	6	361	0.9	0.9	235	1.3	1.1	3	181	5.2	1.9	0.9	511	3.0	0.9	0.7	8	132	4.6	1.7	1.5
					8	203	1.3	1.3	132	1.7	1.5	4	102	6.9	2.6	1.3	287	4.0	1.3	0.9	10	84	5.8	2.1	1.8
					10	130	1.6	1.6	84	2.1	1.8	5	65	8.7	3.2	1.6	184	5.0	1.6	1.1	12	59	6.9	2.5	2.2
					12	90	1.9	1.9	59	2.5	2.2	6	45	10.4	3.8	1.9	128	6.0	1.9	1.3	14	43	8.1	2.9	2.5
					14	66	2.2	2.2	43	2.9	2.5	7	33	12.1	4.5	2.2	94	7.0	2.2	1.6	16	33	9.2	3.4	2.9
	FL	27°	2000	3100	6	86	2.9	2.9	56	3.9	3.3	3	43	5.2	7.0	2.9	122	3.0	3.1	2.0	4	126	2.3	2.6	2.2
					8	48	3.8	3.8	31	5.2	4.4	4	24	6.9	9.3	3.8	69	4.0	4.1	2.7	6	56	3.5	3.9	3.3
					10	31	4.8	4.8	20	6.5	5.5	5	16	8.7	11.6	4.8	44	5.0	5.1	3.4	8	31	4.6	5.2	4.4
					12	22	5.8	5.8	14	7.8	6.7	6	11	10.4	13.9	5.8	30	6.0	6.1	4.1	10	20	5.8	6.5	5.5
	FL	40°	2000	2000	6	56	4.0	4.0	36	5.6	4.6	3	28	5.2	12.1	4.0	79	3.0	4.5	2.8	4	81	2.3	3.7	3.1
					8	31	5.4	5.4	20	7.4	6.2	4	16	6.9	16.1	5.4	44	4.0	6.0	3.8	6	36	3.5	5.6	4.6
					10	20	6.7	6.7	13	9.3	7.7	5	10	8.7	20.1	6.7	28	5.0	7.5	4.7	8	20	4.6	7.4	6.2
12					14	8.0	8.0	9	11.1	9.3	6	7	10.4	24.1	8.0	20	6.0	9.0	5.7	10	13	5.8	9.3	7.7	
					14	10	9.4	9.4	7	13.0	10.8	7	5	12.1	**	9.4	14	7.0	10.5	6.6	12	9	6.9	11.1	9.3

The beam spread in degrees and the beam "L" and "W" in the following tables are computed at 50% of centerbeam candlepower and represent areas of "effective illumination."

**Due to steep aiming angle, length of beam extends beyond 25'.

12V MR16 HALOGEN LAMPS (not integral lens)

Cat. No.	ANSI Code	Watts	Description	Avg. Life (Hrs.)*
T521	ESX	20	Q20MR16/NSP	5000
T522	BAB	20	Q20MR16/FL	5000
T523	FRA	35	Q35MR16/SP	5000
T526	EXT	50	Q50MR16/NSP	6000
T527	EXZ	50	Q50MR16/NFL	6000
T528	EXN	50	Q50MR16/FL	6000



1300 S. Wolf Road • P.O. Box 5065 • Des Plaines, IL 60017-5065 • Phone (847) 827-9880 • Fax (847) 827-2925

220 Chrysler Drive • Brampton, Ontario • Canada L6S 6B6 • Phone (905) 792-7335 • Fax (905) 792-0064

Visit us at www.junolightinggroup.com

Printed in U.S.A. ©2005 Juno Lighting, Inc.