

H7T

H7RT

H7TNB

70- Albalite Lens

- White Trim, Frosted Glass Albalite Lens
- PS version is wet location listed and AIR-TITE for use in showers with non conductive, non corrosive polymer trim
- Torsion spring retention
- Lamps:

H7T H7RT	60W A19
-------------	---------

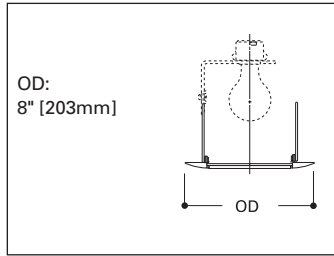

70PS
Wet Location and AIR-TITE listed
White Trim with Frosted Albalite
Lens*

70P
White Trim with Frosted
Albalite Lens

170- Albalite Lens with Reflector

- White Trim with Frosted Glass Albalite Lens
- PS version is wet location listed for use in showers with non conductive, non corrosive polymer trim
- Torsion spring retention
- Lamps:

H7T H7TNB	60W A19
--------------	---------

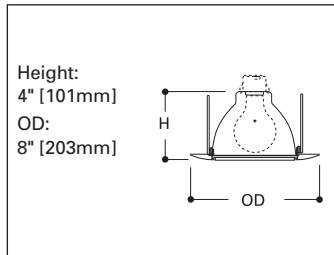

170PS
Wet Location and AIR-TITE listed
White Trim with Frosted Albalite
Lens*

170P
White Trim with Frosted
Albalite Lens

71 - Drop Opal Lens

- White Trim, Drop Opal Lens
- PS version is wet location listed and AIR-TITE for use in showers with non conductive, non corrosive polymer trim
- Torsion spring retention
- Lamps:

H7T H7RT	60W A19
-------------	---------

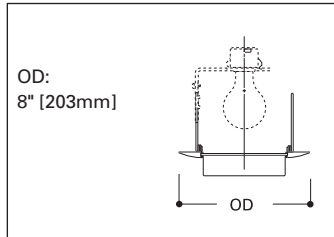

71PS
Wet Location and AIR-TITE listed
White Trim with Drop Opal Lens*

71P
White Trim with Drop Opal
Lens

171- Drop Opal Lens with Reflector

- White Trim with Drop opal Lens
- PS version is wet location listed and AIR-TITE for use in showers with non conductive, non corrosive polymer trim
- Torsion spring retention
- Lamps:

H7TNB	60W A19
-------	---------

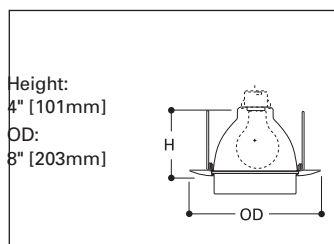

171PS
Wet Location and AIR-TITE listed
White Trim with Drop Opal Lens*

171P
White Trim with Drop Opal
Lens

73- Fresnel Lens

- White Trim with Fresnel Lens
- PS version is wet location listed and AIR-TITE for use in showers with non conductive, non corrosive polymer trim
- Torsion spring retention
- Lamps:

H7T H7RT	60W A19
-------------	---------

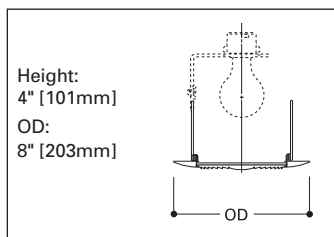

73PS
Wet Location and AIR-TITE listed
White Trim with Fresnel Lens*

73P
White Trim with Fresnel Lens

173 - Fresnel Lens with Reflector

- White Trim with Fresnel Lens
- PS version is wet location listed and AIR-TITE for use in showers with non conductive, non corrosive polymer trim
- Torsion spring retention
- Lamps:

H7TNB	60W A19
-------	---------

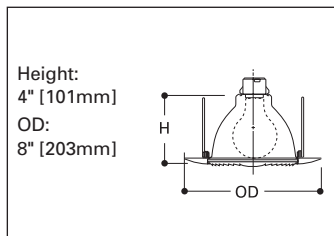

173PS
Wet Location and AIR-TITE listed
White Trim with Fresnel Lens*

173P
White Trim with Fresnel Lens

* When using an Air-Tite trim to meet California Title 24 air tight compliance, an additional gasket is required between the finished ceiling and the trim flange ring. For California Title 24 compliance use accessory trim gasket GA-ATRIM. Order separately in a 6 pack: GA-ATTRIM-6PK

H7UICT

H7UICAT

70- Albalite Lens

- White Trim, Frosted Glass Albalite Lens
- PS version is wet location listed and AIR-TITE for use in showers with non conductive, non corrosive polymer trim
- Torsion spring retention
- Lamps:

H7UICT	40W A19
H7UICAT	

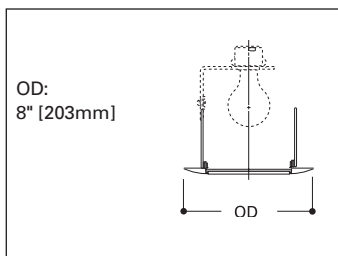

70PS
Wet Location and AIR-TITE listed
White Trim with Frosted Albalite
Lens*

70P
White Trim with Frosted
Albalite Lens

170- Albalite Lens with Reflector

- White Trim with Frosted Glass Albalite Lens
- PS version is wet location listed for use in showers with non conductive, non corrosive polymer trim
- Torsion spring retention
- Lamps:

H7UICT	60W A19
H7UICAT	

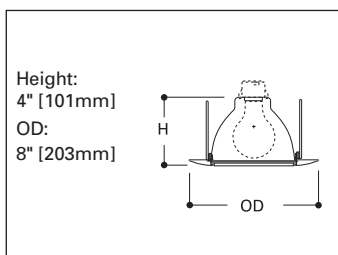

170PS
Wet Location and AIR-TITE listed
White Trim with Frosted Albalite
Lens*

170P
White Trim with Frosted
Albalite Lens

71 - Drop Opal Lens

- White Trim, Drop Opal Lens
- PS version is wet location listed and AIR-TITE for use in showers with non conductive, non corrosive polymer trim
- Torsion spring retention
- Lamps:

H7UICT	40W A19
H7UICAT	

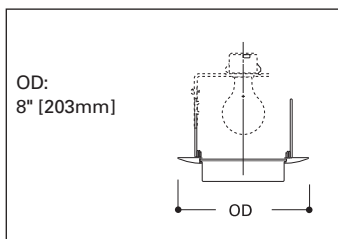

71PS
Wet Location and AIR-TITE listed
White Trim with Drop Opal Lens*

71P
White Trim with Drop Opal
Lens

171- Drop Opal Lens with Reflector

- White Trim with Drop opal Lens
- PS version is wet location listed and AIR-TITE for use in showers with non conductive, non corrosive polymer trim
- Torsion spring retention
- Lamps:

H7UICT	60W A19
H7UICAT	

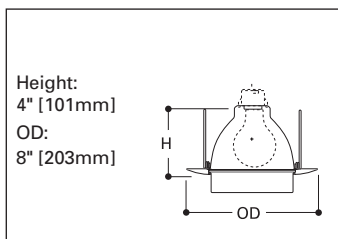

171PS
Wet Location and AIR-TITE listed
White Trim with Drop Opal Lens*

171P
White Trim with Drop Opal
Lens

73- Fresnel Lens

- White Trim with Fresnel Lens
- PS version is wet location listed and AIR-TITE for use in showers with non conductive, non corrosive polymer trim
- Torsion spring retention
- Lamps:

H7UICT	40W A19
H7UICAT	

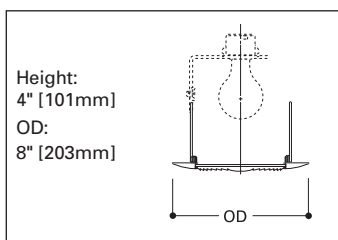

73PS
Wet Location and AIR-TITE listed
White Trim with Fresnel Lens*

73P
White Trim with Fresnel Lens

173 - Fresnel Lens with Reflector

- White Trim with Fresnel Lens
- PS version is wet location listed and AIR-TITE for use in showers with non conductive, non corrosive polymer trim
- Torsion spring retention
- Lamps:

H7UICT	60W A19
H7UICAT	

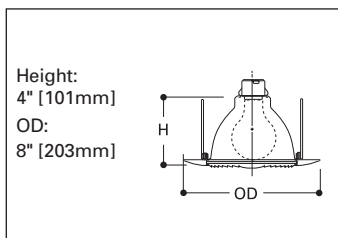

173PS
Wet Location and AIR-TITE listed
White Trim with Fresnel Lens*

173P
White Trim with Fresnel Lens

* When using an Air-Tite trim to meet California Title 24 air tight compliance, an additional gasket is required between the finished ceiling and the trim flange ring. For California Title 24 compliance use accessory trim gasket GA-ATRIM. Order separately in a 6 pack: GA-ATTRIM-6PK

71 - Drop Opal Lens

- White Trim, Drop Opal Lens
- PS version is wet location listed and AIR-TITE for use in showers with non conductive, non corrosive polymer trim
- Torsion spring retention
- Lamps:

H27T	60W A19
-------------	---------

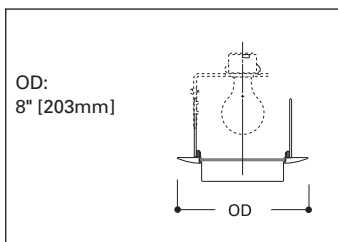

71PS
Wet Location and AIR-TITE listed
White Trim with Drop Opal Lens*

71P
White Trim with Drop Opal
Lens

171- Drop Opal Lens with Reflector

- White Trim with Drop opal Lens
- PS version is wet location listed and AIR-TITE for use in showers with non conductive, non corrosive polymer trim
- Torsion spring retention
- Lamps:

H27RT	60W A19
--------------	---------

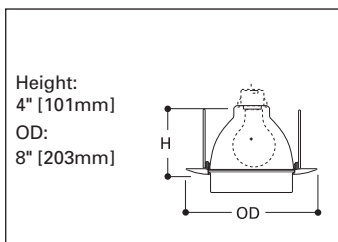

171PS
Wet Location and AIR-TITE listed
White Trim with Drop Opal Lens*

171P
White Trim with Drop Opal
Lens

73- Fresnel Lens

- White Trim with Fresnel Lens
- PS version is wet location listed and AIR-TITE for use in showers with non conductive, non corrosive polymer trim
- Torsion spring retention
- Lamps:

H27T	40W A19
-------------	---------

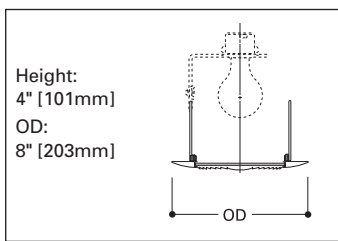

73PS
Wet Location and AIR-TITE listed
White Trim with Fresnel Lens*

73P
White Trim with Fresnel Lens

173 - Fresnel Lens with Reflector

- White Trim with Fresnel Lens
- PS version is wet location listed and AIR-TITE for use in showers with non conductive, non corrosive polymer trim
- Torsion spring retention
- Lamps:

H27RT	60W A19
--------------	---------

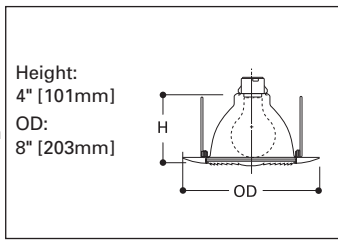

173PS
Wet Location and AIR-TITE listed
White Trim with Fresnel Lens*

173P
White Trim with Fresnel Lens

75 Diffuser

- All glass diffuser
- Provides some illumination on the ceiling plane
- Lamps:

H27T	60W A19
-------------	---------

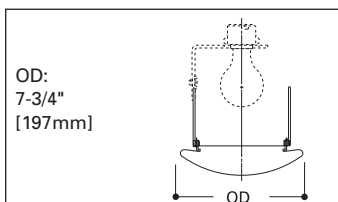

75
All Glass Diffuser

H274 H274HP **H275 H276HP** **H274IC**

71- Drop Opal

- White Trim, Drop Opal Lens
- PS version is wet location listed and AIR-TITE for use in showers with non conductive, non corrosive polymer trim
- Torsion spring retention
- Lamps:

<p>H274 H274HP H275 H276HP H274R H274RHP H274IC</p>	<p>F13DTT 2-pin</p>
--	---------------------

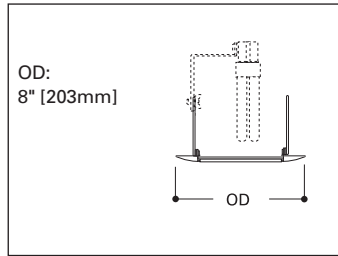

71PS
Wet Location and AIR-TITE listed
White Trim with Drop Opal Lens*

71P
White Trim with Drop Opal Lens

73 Fresnel Lens

- Features:
- White Trim with Fresnel Lens
 - Wet location listed for use in showers
 - Lamps:

<p>H274 H274HP H275 H276HP H274R H274RHP H274IC</p>	<p>F13DTT 2-pin</p>
--	---------------------

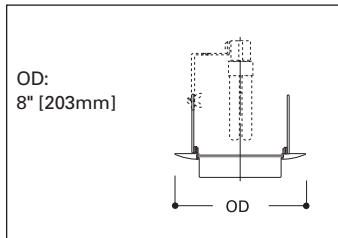

73PS
Wet Location and AIR-TITE listed
White Trim with Fresnel Lens*

73P
White Trim with Fresnel Lens

270 Albalite Lens with Reflector

- White Trim with Frosted Glass Albalite Lens
- Wet location listed for use in showers
- Lamps:

<p>H274 H274HP H275 H276HP H274R H274RHP H274IC</p>	<p>F13DTT 2-pin</p>
--	---------------------

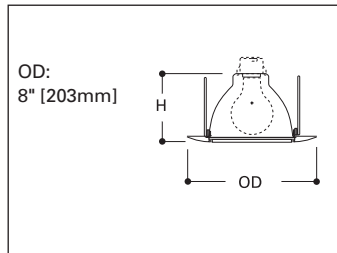

270PS
Wet Location listed White Trim
with Frosted Albalite Lens

* When using an Air-Tite trim to meet California Title 24 air tight compliance, an additional gasket is required between the finished ceiling and the trim flange ring. For California Title 24 compliance use accessory trim gasket GA-ATTRIM. Order separately in a 6 pack: GA-ATTRIM-6PK

**406
Specular Reflector**

- Full reflector
- Torsion spring retention
- Lamps:

H280E/H280EL	18WTTT/18W DTT
H283E/H283EL	18WTTT/18W DTT
H285E/H285EL	26WTTT/26W DTT
H287E/H287EL	26WTTT/26W DTT
H280EICAT	18WTTT/18W DTT
H285EICAT	26WTTT/26W DTT
H280ELICAT	18WTTT/18W DTT
H285ELICAT	26WTTT/26W DTT

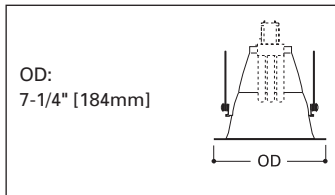

OD:
7-1/4" [184mm]



406RG
White Trim with Gold Reflector

406SC
White Trim with Clear Specular Reflector

406BA - Baffle

- Full reflector
- Torsion spring retention
- Lamps:

H280E/H280EL	18WTTT/18W DTT
H283E/H283EL	18WTTT/18W DTT
H285E/H285EL	26WTTT/26W DTT
H287E/H287EL	26WTTT/26W DTT
H280EICAT	18WTTT/18W DTT
H285EICAT	26WTTT/26W DTT
H280ELICAT	18WTTT/18W DTT
H285ELICAT	26WTTT/26W DTT

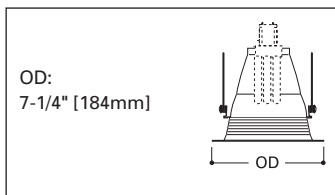

OD:
7-1/4" [184mm]



406WB
White Trim with White Baffle

406BA
White Trim with Black Baffle

70 - Albalite Lens

- White Trim with Frosted Glass Albalite Lens - torsion spring retention
- PS version is wet location listed and AIR-TITE for use in showers with non conductive, non corrosive polymer trim
- Lamps:

H280E/H280EL	18WTTT/18W DTT
H283E/H283EL	18WTTT/18W DTT
H285E/H285EL	26WTTT/26W DTT
H287E/H287EL	26WTTT/26W DTT
H280EICAT	18WTTT/18W DTT
H285EICAT	26WTTT/26W DTT
H280ELICAT	18WTTT/18W DTT
H285ELICAT	26WTTT/26W DTT

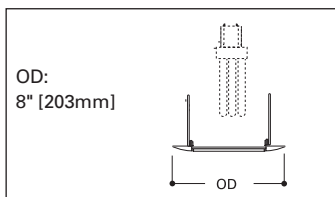

OD:
8" [203mm]



70PS
Wet Location listed White Trim with Frosted Albalite Lens

70P
White Trim with Frosted Albalite Lens

71 - Drop Opal Lens

- White Trim with glass Drop opal Lens - torsion spring retention
- PS version is wet location listed and AIR-TITE for use in showers with non conductive, non corrosive polymer trim
- Lamps:

H280E/H280EL	18WTTT/18W DTT
H283E/H283EL	18WTTT/18W DTT
H285E/H285EL	26WTTT/26W DTT
H287E/H287EL	26WTTT/26W DTT
H280EICAT	18WTTT/18W DTT
H285EICAT	26WTTT/26W DTT
H280ELICAT	18WTTT/18W DTT
H285ELICAT	26WTTT/26W DTT

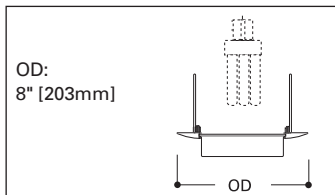

OD:
8" [203mm]



71PS
Wet Location listed White Trim with Drop Opal Lens

71P
White Trim with Drop Opal Lens

73 - Fresnel Lens

- White Trim with glass Fresnel Lens - torsion spring retention
- PS version is wet location listed and AIR-TITE for use in showers with non conductive, non corrosive polymer trim
- Lamps:

H280E/H280EL	18WTTT/18W DTT
H283E/H283EL	18WTTT/18W DTT
H285E/H285EL	26WTTT/26W DTT
H287E/H287EL	26WTTT/26W DTT
H280EICAT	18WTTT/18W DTT
H285EICAT	26WTTT/26W DTT
H280ELICAT	18WTTT/18W DTT
H285ELICAT	26WTTT/26W DTT

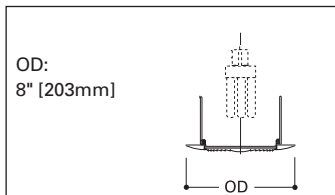

OD:
8" [203mm]



73PS
Wet Location listed White Trim with Fresnel Lens

73P
White Trim with Fresnel Lens