

VAN15S50

JOB NAME: _____

DATE: _____

TYPE: _____

DESCRIPTION

11" or 15" round fixture. 35, 50, 70, 100 & 150w HPS lamp or 50, 70 & 100 watt Metal Halide. Housing is die formed heavy gauge aluminum in bronze enamel finish with clear vandalproof polycarbonate refractor. Lamps supplied.

SPECIFICATIONS

Fluorescent Ballast Starting Temperatures: Sockets:

Electronic QT: 0° F/ -18° C NPF 120V: 32° F / 0° C HPS & MH: Medium base 4kv Pulse Rated Glazed porcelain CFL: Plug-in type, thermoplastic UL Listing.

Reflectors / Backplate:

Heavy gauge cold rolled steel with high reflectance baked white enamel

Refractor:

Injection molded polycarbonate, designed for maximum structural strength

Screws:

Tamperproof center pin Torx-head and slotted Phillips head stainless steel screws provided. Be sure to order your Torx screwdriver (Catalog # VANDRIVER)

Suitable for wet locations. Fixtures can be wired with 90° C supply wiring if supply wires are routed 3" away from ballast.

Patents:

RAB sensor and fixture designs are protected under U.S. and International Intellectual Property laws

Color:

White

Weight:

9.5

DIMENSIONS

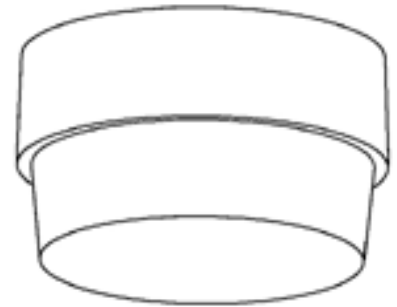

PHOTOMETRIC

100w HPS @ 8' Mounting Height

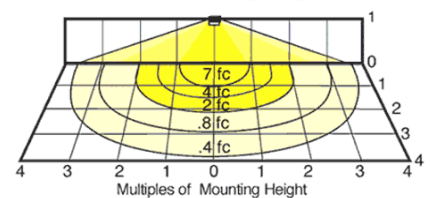

Mounting Height	Multiplier	Watts	Multiplier HPS	MH	CFL
8'	1.0	35	.2		
9'	.8	50	.4		
10'	.7	70	.6		
12'	.4	100	1.0	.9	
14'	.3	150	1.6		
		64			.5

ORDERING INFORMATION

High Pressure Sodium
Lamp supplied with fixture

Total Watts	Lamp Type	Lamp Base	Ballast
50	ED17	Medium	R-NPF 120V

Starting Amps/ Operating Amps			
120V	208V	240V	277V
1.8	1.2		

Input Watts	LAMP ANSI	Initial Lumens	Lamp Hours
62	S68	4000	24000

Factory Installed Options
Add suffix to Catalog Number

Swivel Photocontrol (/PCS)
Quartz Restrike (HPS & MH only) (/QR)

Mini Motion Sensor (/MS)
Button Photocontrol (/PC)

Note: Specifications may change without notice